

Bronze Horiz. Lift Check Valve

Class 150 • Union Cap • Threaded Ends

Product no. 133100-150ht **Features**

Size Range:

1/2 through 3 inches

Max. temperature limit is 450°F (232°C)

Working Pressures

Non-Shock:

150 psi Steam, Basic Rating

300 psi Cold Working Pressure

- Rugged and proven dependable on general services.
- Union Cap construction is an excellent feature for fast, simple maintenance.
- Disc holder is guided top and bottom.
- PTFE disc suitable for steam service.
- MSS Specification SP-80

Note:

For horizontal installation only.

For more details please contact:
export@oswalvalve.com

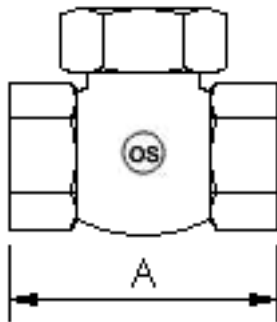
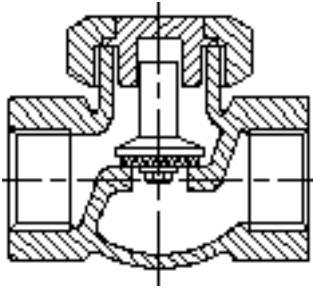

Principal Parts & Materials

Part	Material	ASTM
Body	Bronze	B62 alloy C83600
Cap	Bronze	B62 alloy C83600
Cap Nut	Bronze	B62 alloy C83600
Disc holder	Bronze	B62 alloy C83600
Disc	PTFE	-
Guid/Nut	Bronze/ S.S.	B62 alloy C83600

Dimensions and Weights

Millimeters - Kilograms

DN	1/2" 15	3/4" 20	1" 25	1 1/4" 32	1 1/2" 40	2" 50	2 1/2" 65	3" 80
A	70	85	100	115	125	150	180	200
B	35	35	40	50	60	75	80	85
WTS.	0.40	0.70	1.00	1.90	2.90	4.70	10.40	17.60