

# Bronze Horiz. Lift Check Valve

## Class 200 • Union Cap • Threaded Ends

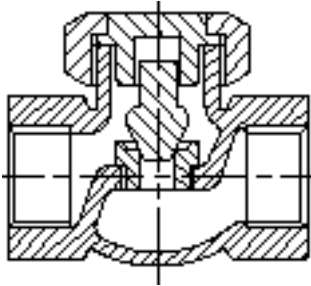

### Product no. 133100-200hs Features

**Size Range:**

1/2 through 3 inches

Max. temperature limit is 450°F (232°C)

**Working Pressures**

**Non-Shock:**

200 psi Steam, Basic Rating

400 psi Cold Working Pressure

- Rugged and proven dependable on general services.
- Union Cap construction is an excellent feature for fast, simple maintenance.
- Disc holder is guided top and bottom.
- **Stainless Steel Seat & Disc Rings**
- MSS Specification SP-80

**Note:**

For horizontal installation only.

For more details please contact:  
export@oswalvalve.com

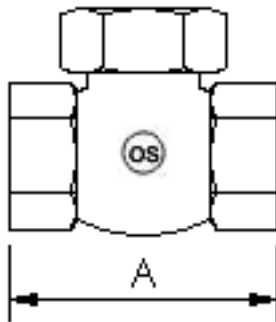

### Principal Parts & Materials

Part	Material	ASTM
Body	Bronze	B62 alloy C83600
Cap	Bronze	B62 alloy C83600
Cap Nut	Bronze	B62 alloy C83600
Disc	Stainless Steel	A276 S41000
Seat Ring	Stainless Steel	A276 S41000

### Dimensions and Weights

Millimeters - Kilograms

DN	1/2" 15	3/4" 20	1" 25	1 1/4" 32	1 1/2" 40	2" 50	2 1/2" 65	3" 80
A	70	85	100	115	125	150	180	200
B	35	35	40	50	60	75	80	85
WTS.	0.50	0.80	1.10	2.00	3.00	4.80	10.50	17.70